

FRAMELESS SHOWER PRODUCTS



Quality Products from

Andscot

the People you can Trust!

www.andscot.com



***Frameless
Shower Door
Catalog 2022***

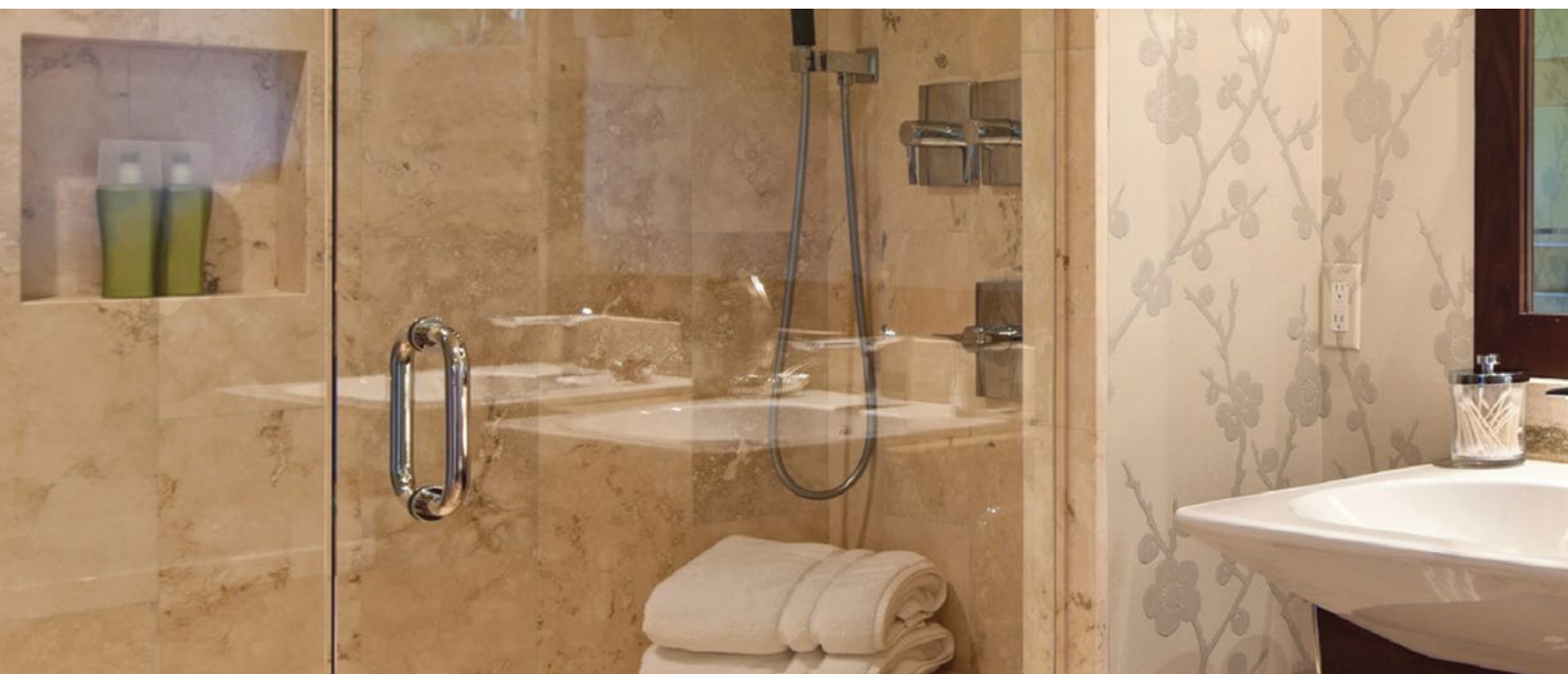

FRAMELESS SHOWER PRODUCTS

High quality hinges, clamps, channels, pulls, headers, and accessories offer numerous design choices in the most popular finishes for glass thicknesses ranging from 1/4" to 1/2".



All shower hinges and clamps feature solid brass construction with internal pins, springs, and screws made from top quality 316 stainless steel.



PRODUCT FEATURES

- Solid Brass & Stainless Steel
- Self-Centering Hinges with reversible 5° pin
- Options for accommodating 1/4" – 1/2" glass
- Options to accommodate up to 36" / 140lb doors
- Finishes include Chrome, Brushed Nickel, Oil Rub Bronze and Matte Black on select products
- 3 Year Warranty
- Special Order Products Available
- Self-Adhesive Gaskets Available
- Standard, Heavy Duty, & Adjustable Hinges Available
- Square & Beveled Components Available
- Fabrication Templates & Hardware Included

SHOWER DOOR BLANKS

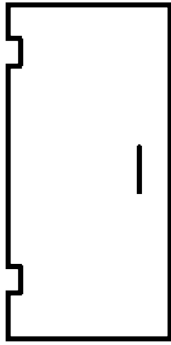

We proud to carry 3/8" shower door blanks. Door blanks are stocked in 3 of the most popular sizes to better serve our customers. The doors feature the popular "Geneva" cut out, and holes for 8" handles. Sizes stocked are:

27 5/8" X 71 5/8"

27 5/8" X 75 5/8"

27 5/8" X 79 5/8"



**FRAMELESS
SHOWER PRODUCTS**

High quality hinges, clamps, channels, pulls, headers, and accessories offer numerous design choices in the most popular finishes for glass thicknesses ranging from 1/4" to 1/2".



All frameless shower hinges, clamps, & pulls are backed by our comprehensive 3 year warranty against any defects in manufacturing and workmanship.



**HARMONY GLIDING
SHOWER DOOR SYSTEM**



Harmony offers you a complete all-in-one shower door hardware system. The system is light, durable, and cost effective.

The minimalist hardware and sleek design create a frameless look that is much more aesthetically pleasing than traditional aluminum framed sliders.



Stocked in Polished Chrome, and Brushed Nickel



**TRANQUILITY GLIDING
SHOWER DOOR SYSTEM**

A modern European style shower door kit. Build your kit in a variety of finishes, tubing choices, and for 1/2" or 3/8" glass.



This system is built from some of the thickest tubing and highest quality hardware in the industry.

Rolling panel can be mounted on either side to accomodate left or right plumbing fixtures.



STANDARD HINGES

FOR 3/8" OR 1/2" GLASS

Capacity: 80lbs using two hinges or 120lbs using three hinges. Solid brass construction with 316 stainless steel mechanisms and electroplated finish. All standard hinges come with a 0° pin that is adjustable to 5° if desired.



Square Edge



Wall Mount Full Back Plate

Part # C50-0004

FINISHES: Black, Bright Chrome, Brushed Nickel, and Oil Rubbed Bronze. Satin Brass

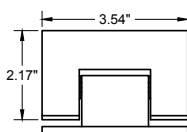

Wall Mount Short Back Plate

Part # C50-0010

FINISHES: Bright Chrome, Brushed Nickel, and Matte Black

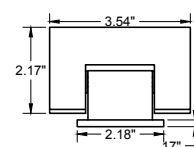

Wall Mount Offset Back Plate

Part # C50-0005

FINISHES: Bright Chrome, Brushed Nickel, and Matte Black

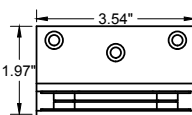

Glass Mount 180°

Part # C50-0006

FINISHES: Bright Chrome, Brushed Nickel, and Matte Black

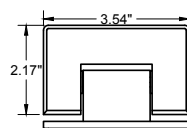
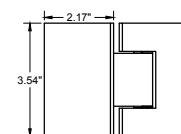

Floor / Ceiling Mount Pivot Hinge

Part # C50-0018

FINISHES: Bright Chrome, Brushed Nickel, and Matte Black

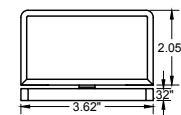

Header Mount Adapter for Pivot Hinge

Part # B42-11684

FINISHES: Bright Chrome, Brushed Nickel, and Oil Rubbed Bronze



FINISH EXAMPLES



Black



Oil Rubbed Bronze



Bright Chrome



Brushed Nickel

HEAVY DUTY HINGES

FOR 1/2" OR 3/8" GLASS

Capacity: 110lbs using two hinges or 140lbs using three hinges. Maximum door width: 36". Solid brass construction with 316 stainless steel mechanisms and electroplated finish. All heavy duty hinges come with a 0° pin that is adjustable to 5° if desired. Fabrication template and installation hardware is included.

Square Edge



Wall Mount Full Back Plate

Part # C50-0011

FINISHES: Chrome, Brushed Nickel, Oil Rub Bronze, Matte Black

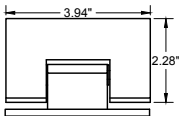

Wall Mount Offset Back Plate

Part # C50-0014*

FINISHES: Bright Chrome, Brushed Nickel, and Oil Rubbed Bronze

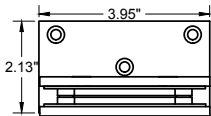

Wall Mount Short Back Plate

Part # C50-0012

FINISHES: Bright Chrome, Brushed Nickel, and Matte Black

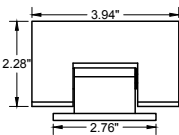

*NON STOCK SPECIAL ORDER

GLASS TO WALL CLAMPS / GLASS TO FLOOR CLAMPS

FOR 1/4" OR 1/2" GLASS

Made of solid 3.5mm or 4.5mm thick brass in black, bright chrome, brushed nickel, or oil rubbed bronze electroplated finish. Fabrication template and installation hardware is included.



2" x 2" Clamp for 3/8" or 1/2" Glass (4.5mm walls)

Part # C50-0033 (Square Edge)

FINISHES: Chrome, Brushed Nickel, Oil Rub Bronze and Matte Black

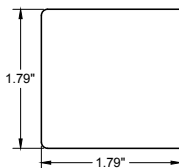

2" x 2" Clamp for 3/8" or 1/2" Glass (4.5mm walls)

Part # C50-0034 (Beveled Edge)

FINISHES: Bright Chrome, Brushed Nickel, and Oil Rubbed Bronze, matte black

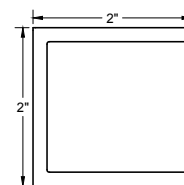

90° Sleeve over clamp

No Fabrication Required

Part # C50-0038

FINISHES: Bright Chrome, Brushed Nickel, and Oil Rubbed Bronze, Matte Black

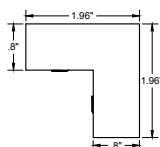

Handles

Handles are made out of stainless steel tubing (type 316) All pulls include plastic gaskets and bushings to prevent glass to metal contact.

Square Pulls & Ladder Pulls



NEW

8" Back to Back to Ladder Style Pulls

Available in Chrome, Brushed Nickel, Matte Black

8" Center to Center, 12" overall length



8" Back-to-Back Pull with removable washer

Part # C60-0056

FINISHES: Bright Chrome, Brushed Nickel, and Oil Rubbed Bronze, Matte Black

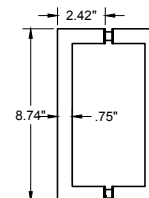

NEW



8" Mitered Corner Handles

Available in Chrome & Brushed Nickel with or without washers

Round Pulls



**6" Back-to-Back Pull
with removable washer**

Part # C60-0006

FINISHES: Bright
Chrome, Brushed
Nickel, and Matte
Black

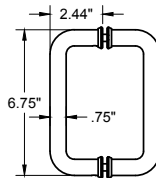

**8" Back-to-Back Pull
with removable washer**

Part # C50-0008

FINISHES: Bright
Chrome, Brushed Nickel,
Oil Rubbed Bronze,
Matte Black, Satin Brass

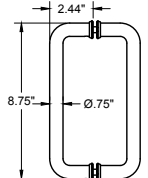

WIPES & SEALS

Our wipes and seals are made from the highest quality polycarbonate, silicone, and/or vinyl for superior clarity and durability.

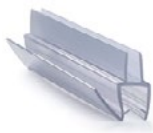

**98" Co-Extruded
Bottom Wipe
with Drip Rail
for 3/8" Glass**

Part # V11-0020

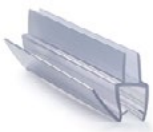

**98" Co-Extruded
Bottom Wipe
with Drip Rail
for 1/2" Glass**

Part # V11-0021



**98" Clear Vinyl
Double Fin Seal
with 5/16"
Applied Tape**

Part # V11-0060

FRAMELESS SHOWER U-CHANNELS AND HEADERS

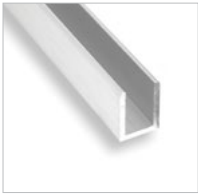

3/8" Glass U-Channel

Part #: ACI-48

FINISHES: Chrome,
Brushed Nickel, Oil Rub
Bronze, Matte Black,
Satin Brass

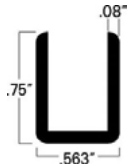

ACI-48 & ACI-52 ARE STOCKED IN 95" AND 144" LENGTHS

ALL FINISHES ARE AVAILABLE IN 95" LENGTHS

144" LENGTHS ARE STOCKED IN CHROME, BRUSHED
NICKEL, MATTE BLACK

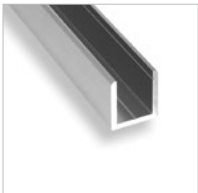

1/2" Glass U-Channel

Part #ACI-52

FINISHES: Chrome,
Brushed Nickel, Oil Rub
Bronze, Matte Black

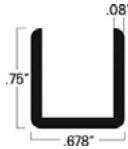

SHOWER HEADER KITS & ACCESSORIES

Header Kit includes header, 3 foot snap in filler, brass mounts and vinyl insert. Header kits are available in 95" lengths in Chrome, Brushed Nickel and Matte Black



Shower Header

FINISHES: Bright Chrome,
Brushed Nickel, and Oil Rubbed
Bronze

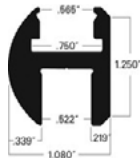

Brass Mounts

Part #B42-9796

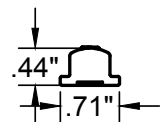

Snap In Filler Insert

FINISHES: Bright Chrome,
Brushed Nickel, and Oil Rubbed
Bronze

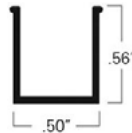

Adjustable Brass Corner

Part #B42-9799

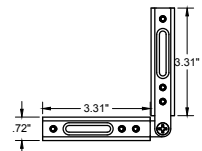

3/8" Glass Clear Vinyl Insert

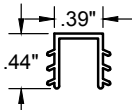

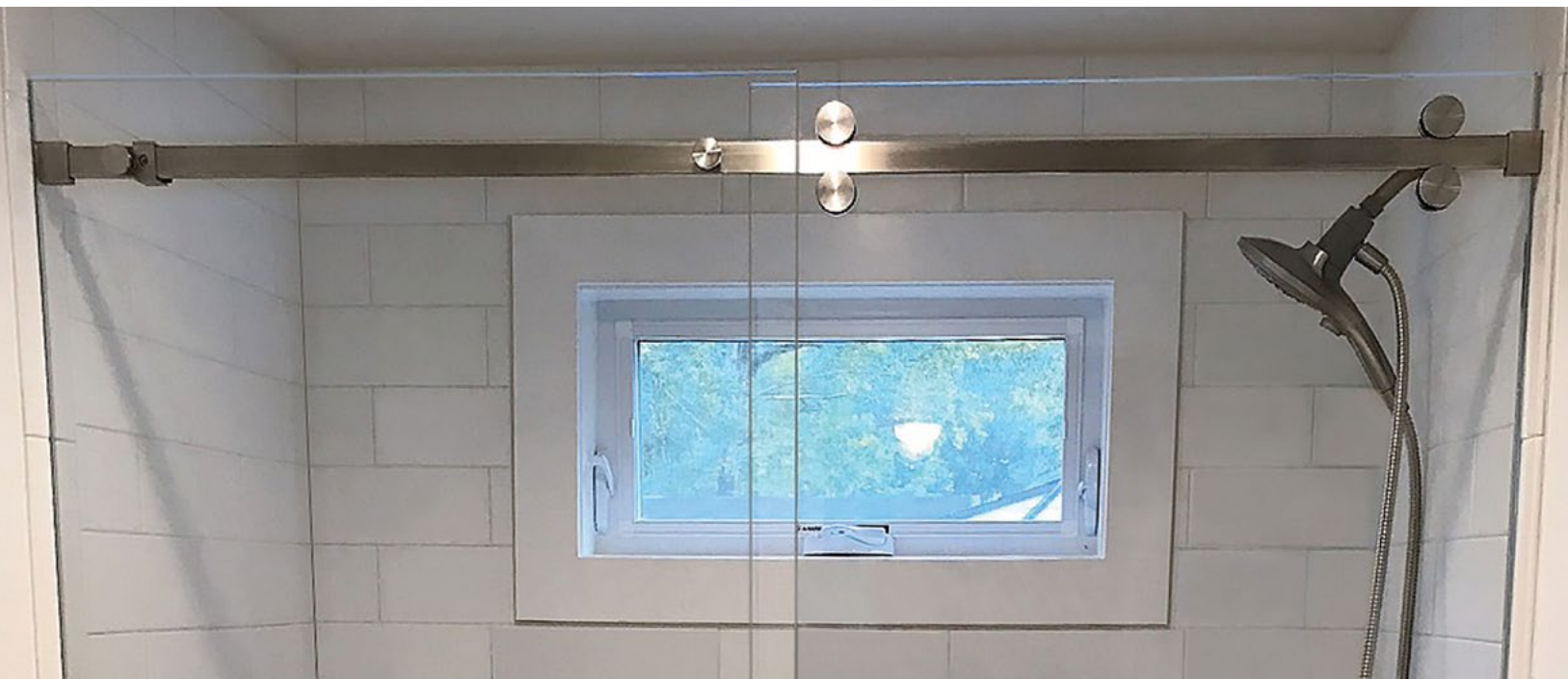

HARMONY GLIDING SHOWER DOOR SYSTEM

The Harmony Gliding Shower Door System uses top quality stainless steel ball bearing wheels that glide quietly and effortlessly across the sturdy rectangular header. It provides a stylish yet affordable option when installing a sliding shower door.

The Harmony Gliding Shower Doors System is designed to work with 5/16" to 3/8" thick tempered glass. It features a one-year warranty against manufacturing defects and is available in" CHROME, BRUSHED STAINLESS AND MATTE BLACK



The minimalist hardware and sleek design creates a frameless look that is much more aesthetically pleasing than traditional framed sliders.



PRODUCT FEATURES

- Durable Stainless Steel Construction
- 4 ball bearing wheels provide security and smooth, quiet operation
- Minimalistic styling
- Fixed and Gliding Panel are reversible for installation
- Available in Polished or Brushed Finish
- Accommodates glass thicknesses from 5/16" to 3/8"
- Maximum Door Size of 30"
- Maximum Door weight of 88lbs
- Compatible with glass return panel
- All Installation Hardware included except clamps or channel for fixed panel
- Comprehensive Instructions including Glass Fabrication Cut-Out Available
- Design Assistance Available

HARMONY SYSTEM DIAGRAM

The Harmony Gliding Shower Door System uses top quality stainless steel ball bearing wheels that glide quietly and effortlessly across the sturdy rectangular header. It provides a stylish yet affordable option when installing a sliding shower door.

KIT INCLUDES (Part #C70-4200):

- Header Tube x 1 (1 - 3/16" x 7/16" x 78")
- Fixed Panel Mount x 2 (1 - 1/8" ø)
- Roller x 4 (1 - 1/2" ø)
- Wall Mount x 2
- Door Pull x 1 (2 - 1/4" ø)
- L-Seal x 1
- Door Guide x 1
- Installation Hardware x 1
- Stopper x 1
- Adjustable Header Mount x 2

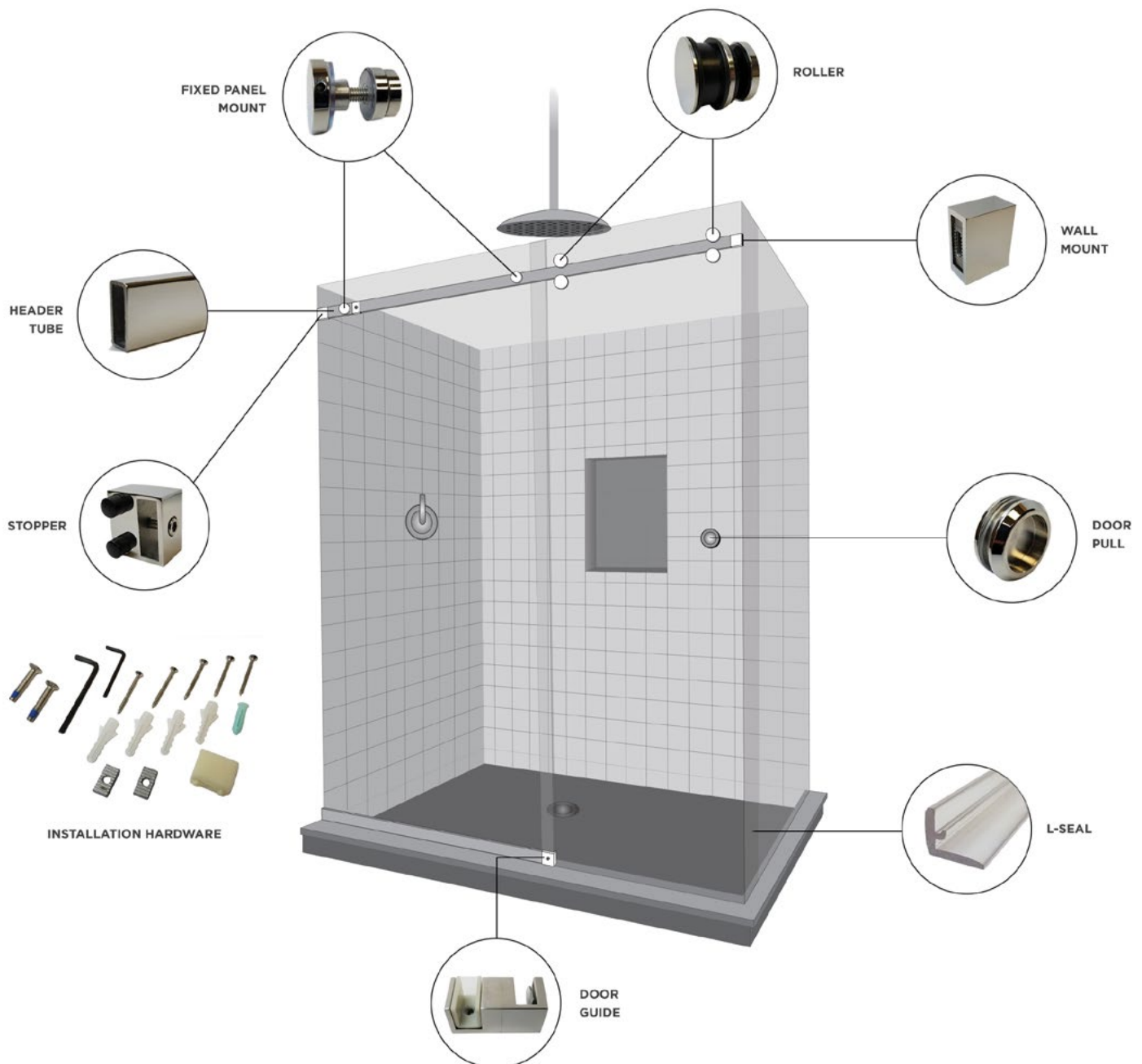

HARMONY SYSTEM KIT

The Harmony Shower System Kit contains all items listed below. It is designed to give the installer everything needed to install the Harmony Gliding Shower Door with the exception of the glass. The kit is available in polished or brushed stainless finishes.



Header Tube

Quantity: 1
Size: 1 - 3/16" x 7/16" x 78"

FINISHES: Polished Stainless
and Brushed Stainless

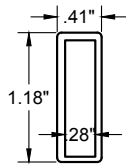

L-Seal

Quantity: 1
Size: see diagram

FINISHES: Polished Stainless
and Brushed Stainless

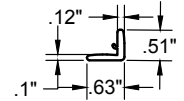

Harmony Roller

Quantity: 4
Size: 1 - 1/2" Ø

FINISHES: Polished Stainless
and Brushed Stainless

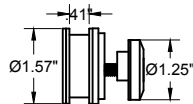

Fixed Panel Mount

Quantity: 2
Size: 1 - 1/8" Ø

FINISHES: Polished Stainless
and Brushed Stainless

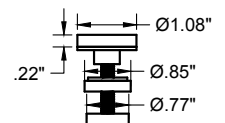

Door Pull

Quantity: 2
Size: 2 - 1/4" Ø

FINISHES: Polished Stainless
and Brushed Stainless

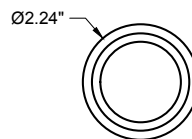

Wall Mount (or) Glass Mount

Quantity: 2
Size: 1.2" x 1.54"

FINISHES: Polished Stainless
and Brushed Stainless

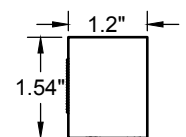

Door Guide

Quantity: 1
Size: .96" x 2.38"

FINISHES: Polished Stainless
and Brushed Stainless

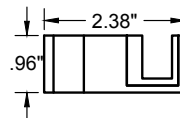

Stopper

Quantity: 1
Size: .87" x 1.42"

FINISHES: Polished Stainless
and Brushed Stainless

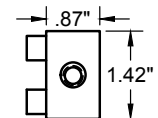



TRANQUILITY GLIDING SHOWER DOOR SYSTEM

A modern European style shower door kit. Built with top quality materials, specially designed not to warp or wear down, this system comes undrilled or with optional pre-tapped holes to accommodate almost any width enclosure up to 78". Build your kit in a variety of finishes, tubing choices, and for 1/2" or 3/8" glass. This system is built from some of the thickest tubing and highest quality hardware in the industry. Rolling panel can be mounted on either side to accommodate left or right plumbing fixtures. **This kit is available via special order. Please allow 5-7 days for hardware to arrive**



A modern European style shower door kit. This system is built from the highest quality hardware and thick walled tubing.



PRODUCT FEATURES

- Top Quality, High End Materials and Appearance
- .098" Heavy Walled SS Tubing
- Heavy-Duty 2 3/4" Japanese Ball Bearing Wheels provide ultra-smooth operation
- All necessary hardware included
- All necessary sweeps and seals included
- 180lb weight capacity
- Accommodates 3/8" or 1/2" glass while maintaining 1-7/16" separation between the panels
- Fixed Panel can be mounted wall to wall or wall to side lite
- Available in polished stainless, brushed stainless, and oil rubbed bronze finish
- 304 stainless steel with electroplated finish
- Roller Wheels allow slight vertical adjustment

TRANQUILITY SHOWER HARDWARE SYSTEM KIT

The Tranquility Shower Hardware System Kit (C70-1200) is available via special order in polished stainless, brushed stainless, and oil rubbed bronze. It includes the following products:



Fixed Panel Clamp

Part # C70-2100

FINISHES: Polished Stainless, Brushed Stainless, and Oil Rubbed Bronze

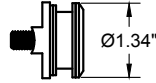

Stopper

Part # C70-2160

FINISHES: Polished Stainless, Brushed Stainless, and Oil Rubbed Bronze

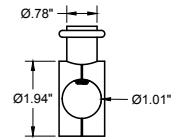

Tube to Wall Bracket

Part # C70-2101

FINISHES: Polished Stainless, Brushed Stainless, and Oil Rubbed Bronze

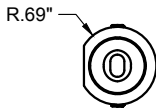

Floor Guide

Part # C70-2162

FINISHES: Polished Stainless, Brushed Stainless, and Oil Rubbed Bronze

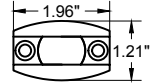

Roller

Part # C70-2120

FINISHES: Polished Stainless, Brushed Stainless, and Oil Rubbed Bronze

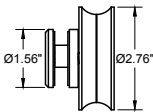

TUBING OPTIONS

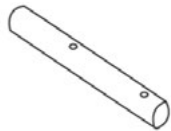

Tubing

Size: 6.5" (2 meters)
Undrilled

Part # C70-2145

FINISHES: Polished Stainless, Brushed Stainless, and Oil Rubbed Bronze

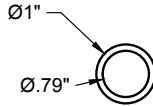

VINYL OPTIONS

Choose V70-1000 for 3/8" glass or V70-2000 for 1/2" glass. All three shapes below included.



Drip Rail



Gliding Door Seal

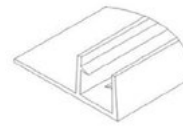

Fixed Panel Seal

OPTIONAL ITEMS



Tubing Connector

Part # C70-2102

FINISHES: Polished Stainless, Brushed Stainless, and Oil Rubbed Bronze

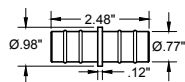

Tube to Glass Bracket

Part # C70-2103

FINISHES: Polished Stainless, Brushed Stainless, and Oil Rubbed Bronze

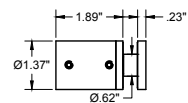

Round Door Pull

Part # C70-2161

FINISHES: Polished Stainless, Brushed Stainless, and Oil Rubbed Bronze

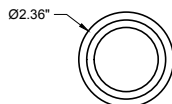

Barrel Nut

Part # C70-2163

FINISHES: Polished Stainless, Brushed Stainless, and Oil Rubbed Bronze

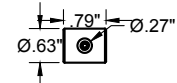

TRANQUILITY SYSTEM DIAGRAM

The Tranquility Gliding Shower Door System components can be ordered separately by individual kit / part number or as a complete system for 3/8" glass using part number C70-1100. Available in Polished Stainless, Brushed Stainless, and Oil Rubbed Bronze.

